

PREMIERING SOON...

In the Ashland-Greenwood Community



Ashland
Greenwood
Community

PERFORMING
ARTS CAMPAIGN

OUR MISSION

Bring the Arts to Ashland-Greenwood

We're on a mission to close the fine arts gap within the rapidly growing Ashland-Greenwood community.

The Ashland-Greenwood Community Performing Arts Center (AGCPAC) will provide a much-needed venue for music, theater and dance performances, and a space to gather in the spirit of arts, humanities and civic engagement. The center will serve Ashland-Greenwood students and the people who live in these communities — while attracting thousands of guests from across Eastern Nebraska and beyond.



Setting the Scene

Nestled between Lincoln and Omaha in close proximity to Mahoney State Park, Ashland is a thriving center of commerce, education and recreation.

The only performing arts venue within a 20-mile radius of this growing community is the Ashland-Greenwood High School gymnasium.

So it's no surprise that choir, band and drama groups must often compete for rehearsal time with basketball and volleyball practices. It's not unusual for students to travel up to 30 miles to rehearse — placing undue financial burden and time strain on families, especially those without financial means to make these trips.

Not only is the high school gym insufficient in meeting the needs of the rapidly growing student population, but it also has inadequate acoustics, lighting and seating for performing arts. The gym's lack of contemporary technology limits its practical use as a public venue.

Ashland-Greenwood's venue deficit limits cultural opportunities for the growing school district and the surrounding community.

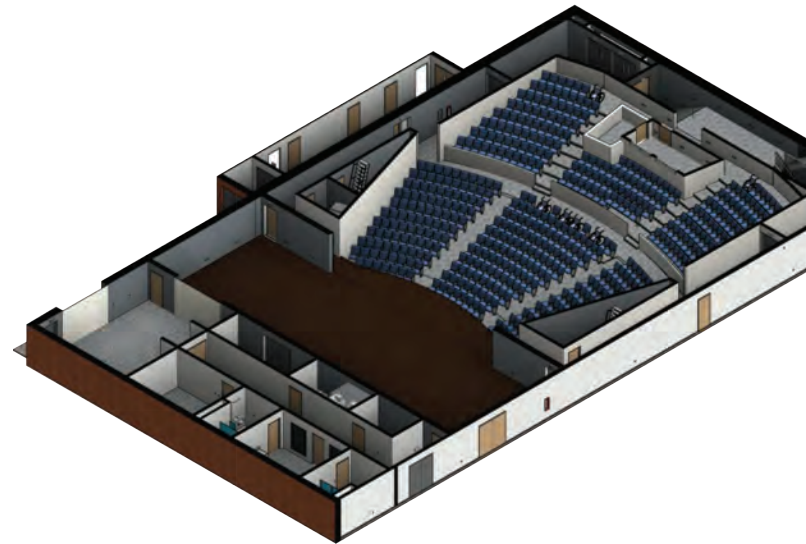

Campaign Goals

Youth Engagement

AGCPAC will provide a much-needed space apart from the high school gymnasium for students to sing, dance and act. Modern technology will also enhance opportunities for students to master sound engineering, light choreography, set design and more.

Economic Advancement

The performing arts center is the opportunity we've been waiting for to invest in our own potential — delivering great economic impact to the entire local region. AGCPAC will serve as a beacon of fine arts, attracting visitors and generating revenue through ticket sales.

Community Connection

At its core, AGCPAC will be a space to gather. The auditorium's layout and tech features make it an optimal venue for school and civic meetings.



Imagine This

A modern, versatile performing arts center design offers the following key features:

- **Capacity for over 700 guests.**
- **Comfortable seating in a traditional auditorium layout, including a balcony.**
- **Exceptional acoustics for all types of musical performance.**
- **A mounted projector and screen for community events and school meetings.**
- **Lighting features to support a wide variety of settings and stages.**
- **A state-of-the-art recording studio.**

Visit agperformingarts.org to learn more and take a virtual tour!

Construction Phase

Estimated Timeline

Footings	April 2022
CMU Walls	May 2022
Steel install at the stage	May 2022
Steel install at the balcony	August 2022
Concrete slab on grade	September 2022
Roofing	October 2022
Framing	November 2022
MEP	December 2022
Stage equipment install	July 2023
Finishes	August 2023
Estimated completion	January 2024



Over Halfway to Curtain Call

Construction is already underway!

By summer 2023, we must raise the final \$2 million to complete this project. This amount represents less than half of the \$4.5 million estimated total cost.



Get Involved

Over the next several months, you have a unique opportunity to help cement Ashland-Greenwood’s legacy of fine arts and economic advancement for decades to come.

Action	Gift	Details and Naming Opportunities
Fund a seat	\$750	With this gift, your family will fund one of 700+ seats in the AGCPAC auditorium. Your donation will be honored with a small plaque inside the performing arts center and a commemorative, limited edition coin in honor of each seat in the auditorium.
Fund a row	Varies	If you, your family or business/organization are interested in purchasing multiple seats in a row, please contact Brent Comstock (brent@bcomonline.com) to discuss custom funding opportunities. This donation will be honored with a medium-sized plaque inside the performing arts center, as well as a commemorative coin for each seat funded.
Oscar’s Club	\$10K+	The performing arts center wouldn’t be complete without the Oscars! While our version of the awards program is a bit different, we want to recognize donors who contribute more than \$10,000 with a \$1,000 tax credit. If you plan to contribute a gift exceeding \$10,000 this credit is available to you; however, these credits are in limited supply. Contribute today to ensure you receive this tax credit!
Bushels for Bach	Pledge Commodities	Our agriculture community is vital to the growth of the Ashland-Greenwood community. We invite our ag producers and community farmers to consider participating in Bushels For Bach by contributing corn or soybean commodities.



Join the Cause

You can give to the AGCPAC campaign online or via check — or pledge your gift through agricultural commodities, appreciated stocks or a special designation of your estate.

Visit our website to learn more
and take a virtual tour!

www.agperformingarts.org

